



KUO CHI MACHINERY CO., LTD.

TEL: +886-4-2491-8626 FAX: +886-4-2491-8627
No. 18, Gongye 12th Rd., Dali Dist., Taichung City 412, Taiwan
✉ s8626@ms23.hinet.net www.kuo-chi.com



More Info

Professional Manufacturer
■ Overhead Conveyors
■ High-Quality Accessories



KUO CHI MACHINERY CO., LTD.
www.kuo-chi.com

Professional Conveying Solutions
Always on Track

Company Overview

Kuo Chi Machinery Co., Ltd. was founded in 1991 and in 1995 we expanded production facilities and relocated to the Dali Industrial Park, Taichung City. Specializing in the production and wholesale of all kinds of conveyor chains and hangers, we have been continuously innovating and improving our automation equipment technologies. The quality and specifications of our products are always in accordance with customer needs, and we also offer excellent customer support. Current production runs are focused on 5 and 7 ton overhead conveyor chains and related accessories, and these systems can be customized on request.

Upholding the principles of “Quality First, Customer First”, Kuo Chi Machinery provides customers with professional products and services at very competitive prices.

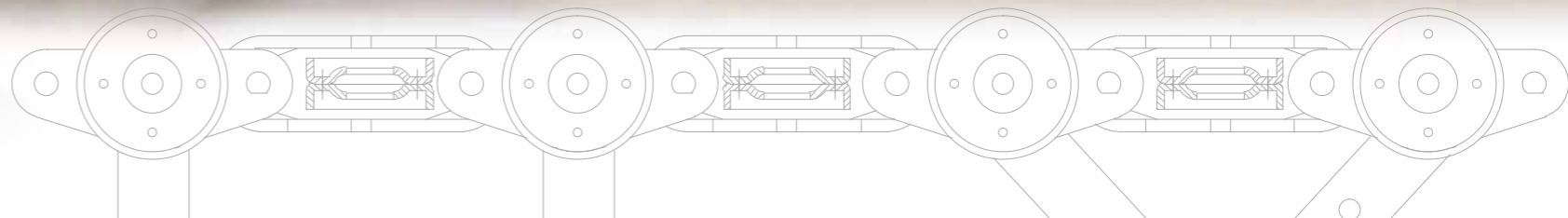

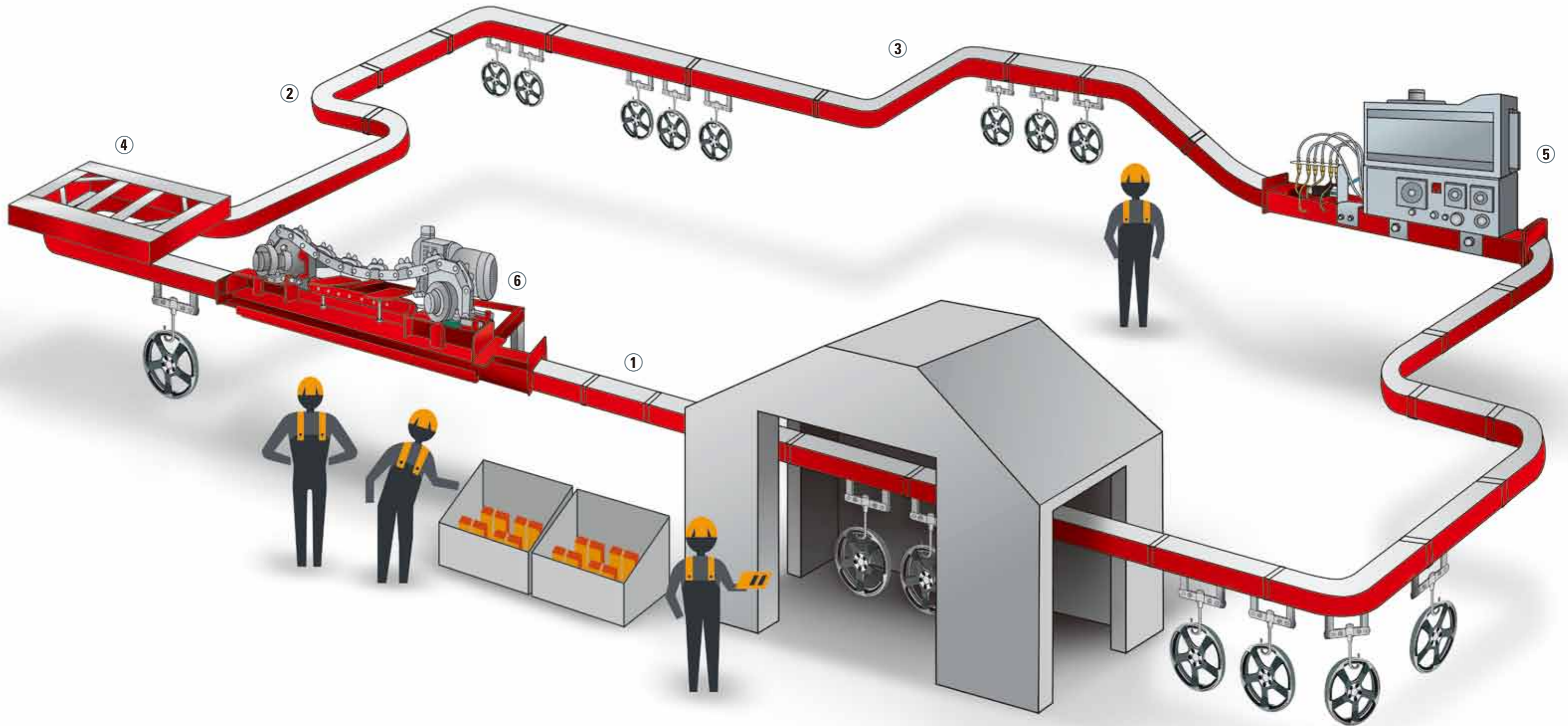

Diagram of Conveyor Components

- ① Straight Track
- ② Horizontal Bends
- ③ Up & Down Inclines
- ④ Adjustment Devices
- ⑤ Auto Lubrication Machine
- ⑥ Caterpillar Drive Unit



2 Ton Overhead Conveyor Chain

Specifications

Type	Load	Pitch	Breaking Strength
2 Ton Conveyor Chain	20 kg	150 m/m	2000 kg



2 Ton - Overhead Conveyor Chain
Standard Type (Above)
Heavy Duty (Below)

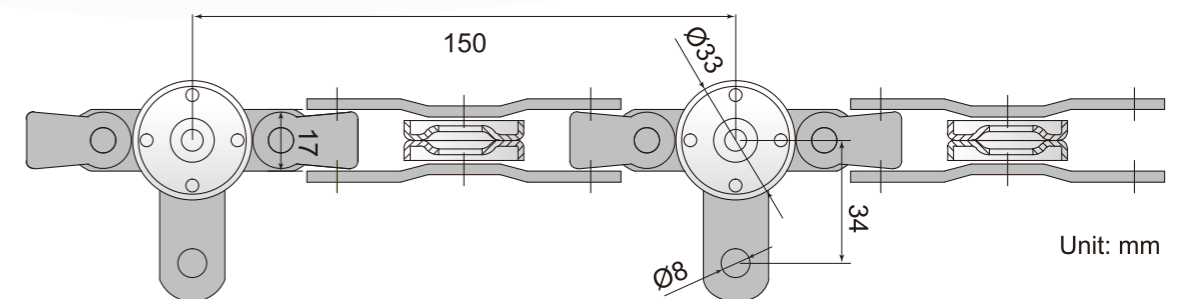

Overhead Conveyor Chains

Conveying tracks can range from simple straight lines to complete circuits, including curves, inclines and switches, to meet all your handling system needs.

It is possible to design conveyors in irregular shapes which are not restricted to straight loop designs, and all conveyors can be used with a variety of coating equipment.

5 Ton Overhead Conveyor Chain

Specifications

Type	Load	Pitch	Breaking Strength
5 Ton Conveyor Chain	50 kg	150 m/m	5000 kg

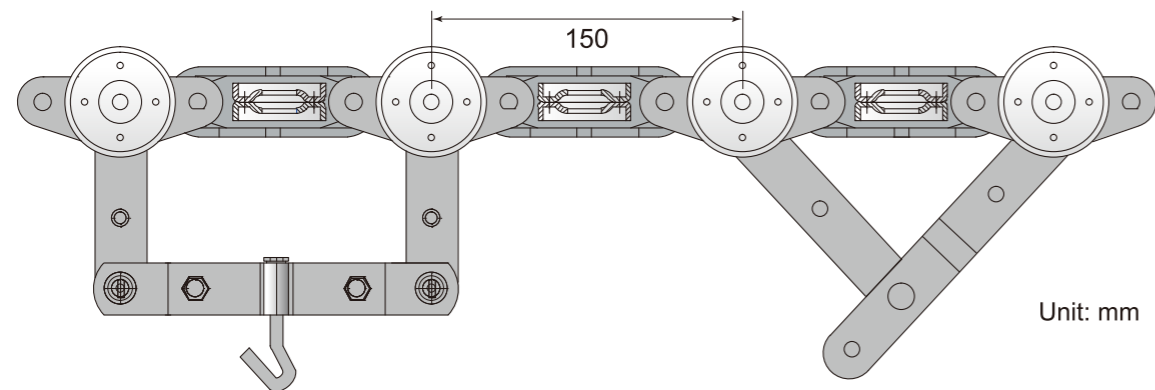

5 Ton - Overhead Conveyor Chain
Standard Type



5 Ton - Overhead Conveyor Chain
Reinforced Bearing



5 Ton - Overhead Conveyor Chain
Heavy Duty



5 Ton - Overhead Conveyor Chain
Heavy Duty (U.S.)



5 Ton - Overhead Conveyor Chain
With Hanger



5 Ton - Overhead Conveyor Chain
With Hanger



7 Ton Overhead Conveyor Chain

Specifications

Type	Load	Pitch	Breaking Strength
7 Ton Conveyor Chain	70 kg	200 m/m	7000 kg

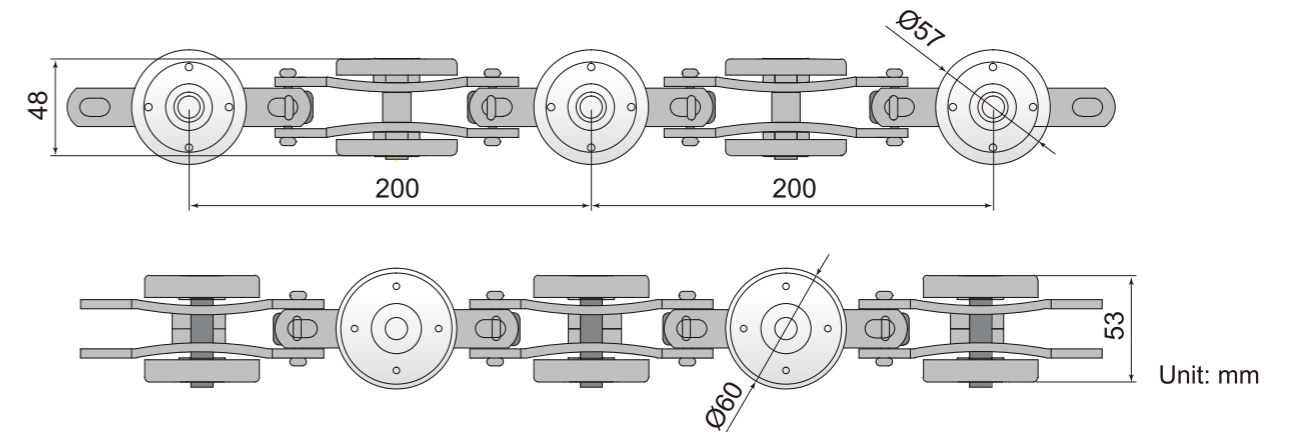

7 Ton - Overhead Conveyor Chain
Standard Type



7 Ton - Overhead Conveyor Chain
With Hanger



7 Ton - Overhead Conveyor Chain
Floor Type



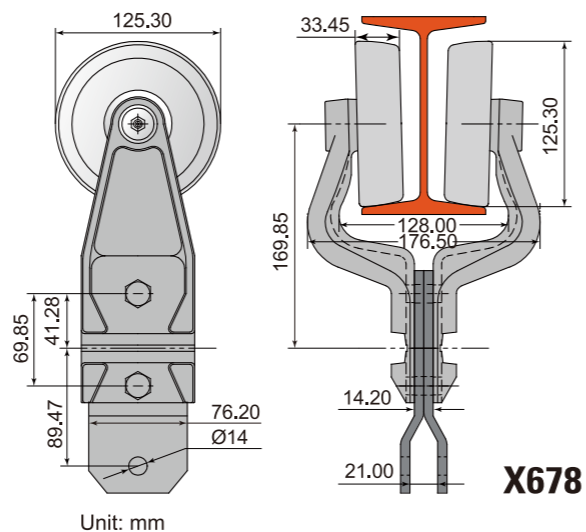
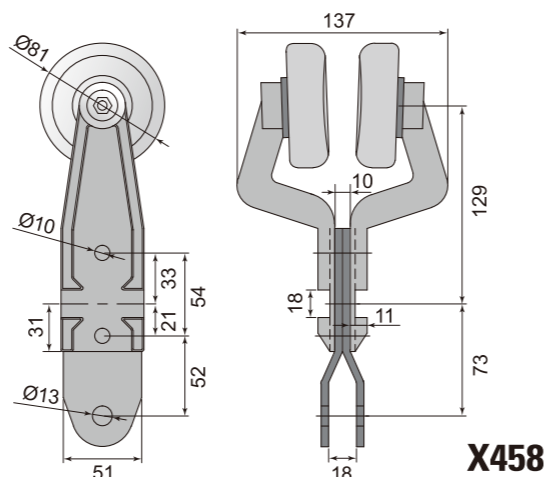
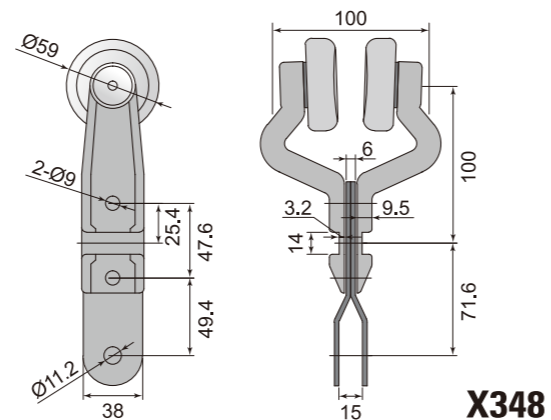

Trolley

Kuo Chi offers a full line of trolleys to fit every application. We have many available options ranging from lightweight to heavy duty, and have trolleys and attachments suitable for any system.

Roller Chains

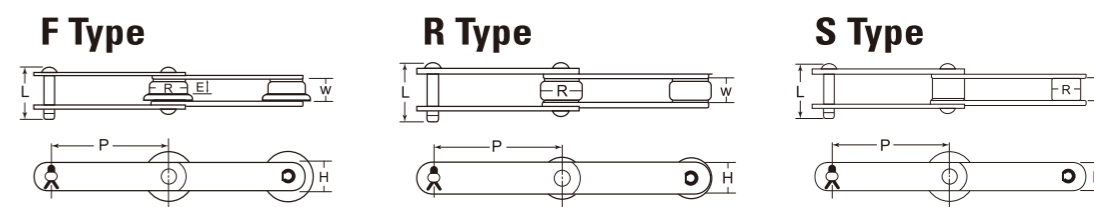

Specifications

Chain No.	Pitch	Roller Dia.		Roller Link Width	E		PIN C	Height	Average Tensile Strength (kg)		Weight (kg/m)		
		R,F	S		R,S	F			Ordinary Type	Intensive Type	R Roller	F Roller	S Roller
		R	R				L						
RF 03075	75	31.8	15.9	16.1	15.5	12	38	22	3,000	7,100	2.7	2.8	1.9
RF 03100	100	31.8	15.9	16.1	15.5	12	38	22	3,000	7,100	2.7	2.4	1.7
RF 430	101.6	38.1	20.1	22.6	19	-	55	25.4	5,500	10,000	4.3	-	3.0
RF 05075	75	40	22.2	22	19	-	53.5	32	7,000	14,500	-	-	4.2
RF 05100	100	40	22.2	22	19	14	53.5	32	7,000	14,500	5.0	5.2	3.7
RF 05150	100	40	22.2	22	19	14		32	7,000	14,500	4.1	4.2	3.2
RF 204	78.11	-	22.2	27	23	-	65.5	28.6	8,000	14,500	-	-	5.6
RF 450	101.6	44.5	22.2	27	23	18	65.5	28.6	8,000	14,500	6.8	7.2	4.6
RF 08150	150	44.5	22.2	27	23	18	65.5	28.6	8,000	14,500	5.5	5.6	4
RF 10100	100	50.8	29	30	27	20	69	38.1	11,500	23,000	9.8	-	6.8
RF 10150	150	50.8	29	30	27	20	69	38.1	11,500	23,000	7.9	8.1	5.9
RF 205	78.11	-	31.8	37.1	-	-	83.5	38.1	13,000	24,500	-	-	10.4
RF 214	101.6	44.5	31.8	31.6	27	-	77.5	38.1	13,000	24,500	10.4	-	8.7
RF 6205	152.4	57.2	34.9	37.1	32	25	83.5	44.5	19,000	24,500	12.1	12.4	9.3
RF 12200	200	65	34.9	37.1	32	24	83.5	44.5	19,000	28,500	11.4	11.9	8.4
RF 12250	250	65	34.9	37.1	32	24	83.5	44.5	19,000	28,500	10.3	10.6	7.8
RF 212	152.4	69.9	40.1	37.1	32.5	-	95.5	50.8	25,000	39,500	17.1	-	12.6
RF 17200	200	80	40.1	51.4	44	34	109.5	50.8	25,000	39,500	18.8	19.8	12.0
RF 17250	250	80	40.1	51.4	44	34	109.5	50.8	25,000	39,500	16.5	17.3	11.1
RF 17300	300	80	40.1	51.4	44	34	109.5	50.8	25,000	39,500	15.0	15.7	10.5
RF 26250	250	100	44.5	57.2	50	38	116.5	63.5	32,000	53,000	25.3	26.2	14.7
RF 26300	300	100	44.5	57.2	50	37	116.5	63.5	32,000	53,000	22.3	23.6	13.8
RF 650	152.4	50.8	25.8	30.2	26	20	69	38.1	8,000	14,500	7.7	8.0	6.0
RF 26450	450	100	44.5	57.2	50	38	116.5	63.5	32,000	53,000	18.0	18.9	12.4
RF 36300	300	125	50.8	66.7	56	42	146	76.2	48,500	69,500	39.0	40.1	22.9
RF 36450	450	125	50.8	66.7	56	42	146	76.2	48,500	69,500	30.7	31.9	20.2
RF 36600	600	125	50.8	66.7	56	42	146	76.2	48,500	69,500	26.9	27.8	19.0
RF 52300	300	140	57.2	77	65	49	172	76.2	51,000	105,000	48.8	52.5	29.7
RF 52450	450	140	57.2	77	65	49	172	76.2	51,000	105,000	37.5	39.3	26.2
RF 52600	600	140	57.2	77	65	49	172	76.2	51,000	105,000	32.9	34.3	24.4

Specifications are subject to change without notice.

Caterpillar Drives

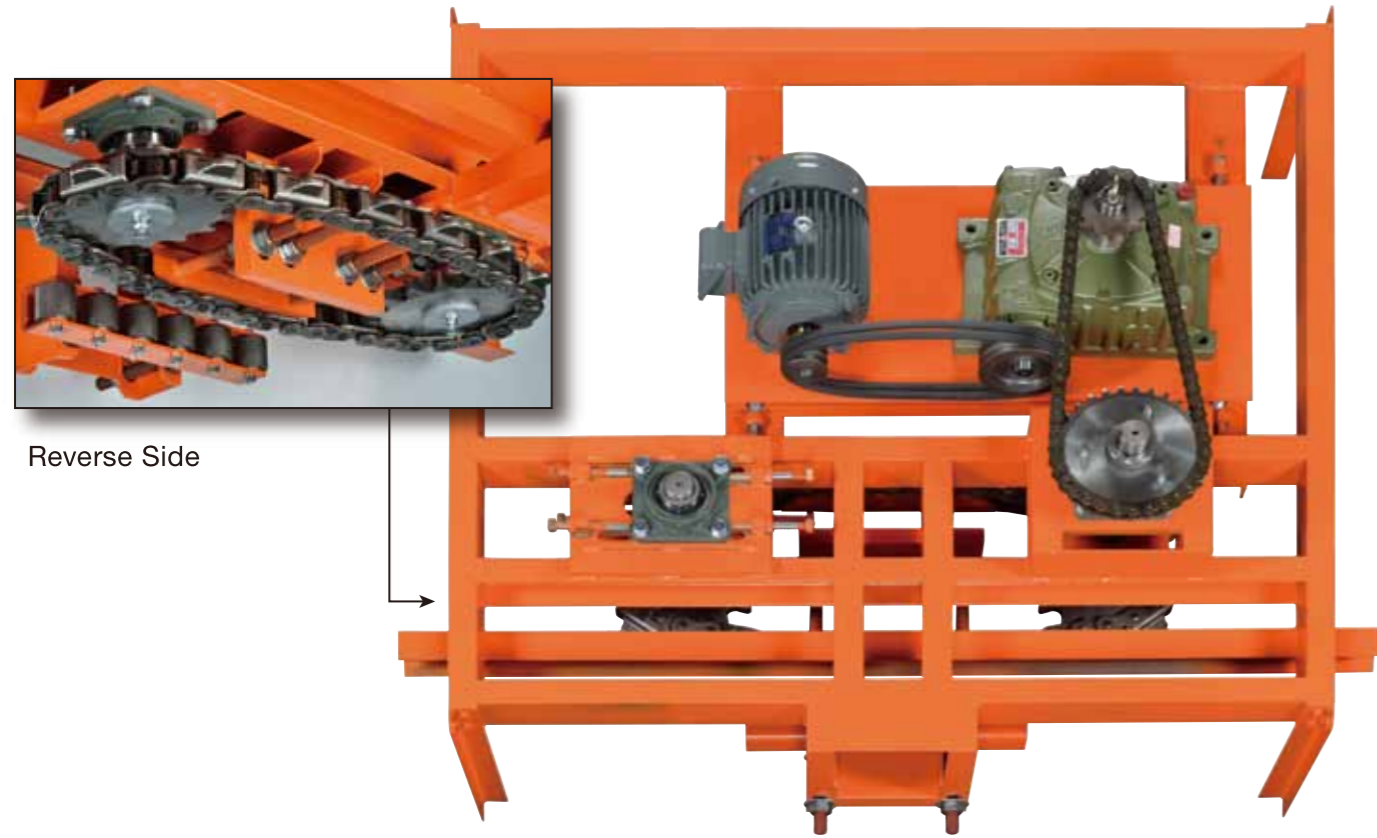

X458 - Caterpillar Drive

Adjustment Devices



5 Ton - Adjustment Device Spring Type

5 Ton - Adjustment Device

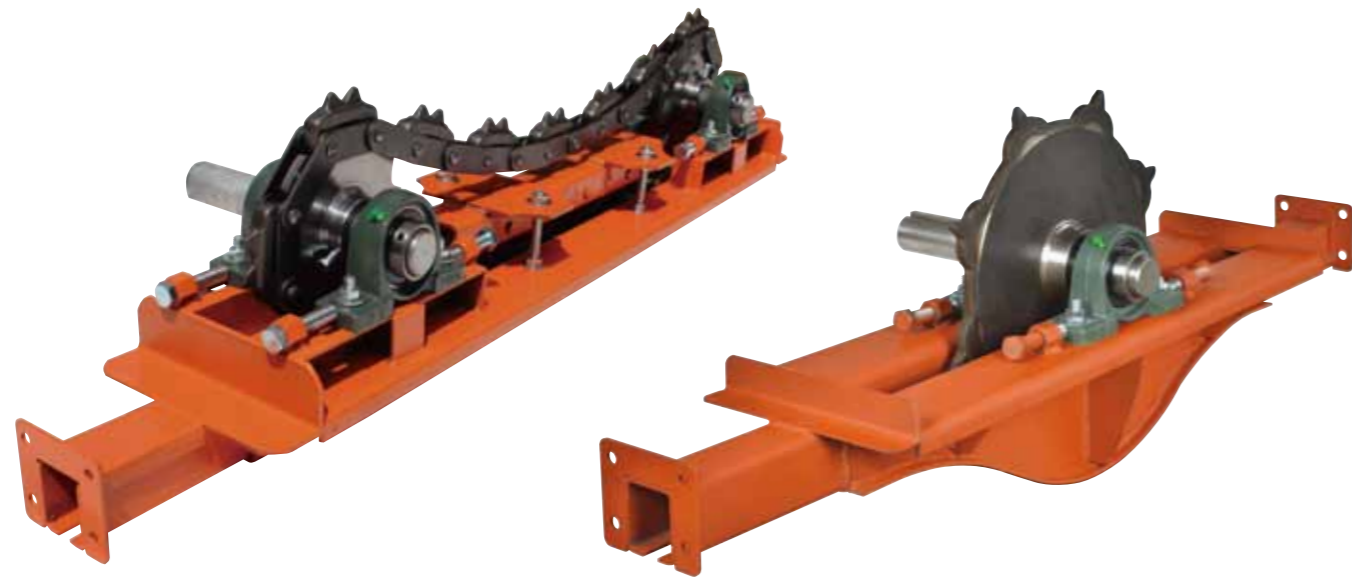

5 Ton - Caterpillar Drive Standard

5 Ton - Caterpillar Drive



X458 - Adjustment Device With Rollers

Track Types



X458 - Traction Wheel



Vertical Curve (Incline)



Horizontal Curve



Vertical Curve (Decline)

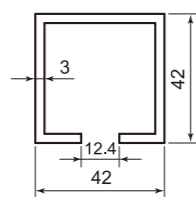

Track for 2 Ton

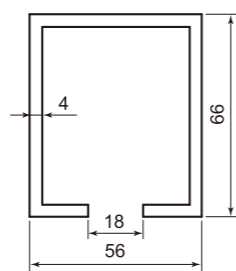

Track for 5 Ton

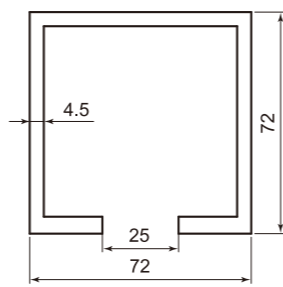

Track for 7 Ton

Hangers for 5Ton Conveyor



5 Ton - Y Type Hanger



5 Ton - Swivel, Cross with Plate (Flat)



Cross Auto Interrupting Bracket



5 Ton - U Type Hanger (Corners)



5 Ton - U Type Hanger (Round)



5 Ton - U Type Hanger (Flat)

Hangers for 7Ton Conveyor



7 Ton - U Type Hanger



7 Ton - C Type Hanger



7 Ton - Upward Hanger

Other Accessories



Flange



Movable Wheel



Water Jet Head

